

# Model F Faspin®

Standard sizes and configurations.

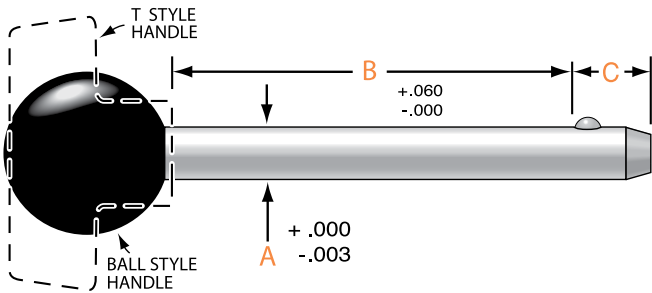

## Ball Handle T Handle

### Model F – Ball Handle

DIAMETER	GRIP OR EFFECTIVE LENGTH	C	Size	Material	Finish	FASPIN P/N ZINC PLATED 1144 STEEL	FASPIN P/N 303 STAINLESS STEEL
3/16	0.5	0.200	3/4	Phenolic	Glossy	F3-05B	F3-05B-303
3/16	0.6	0.200	3/4	Phenolic	Glossy	F3-06B	F3-06B-303
3/16	0.7	0.200	3/4	Phenolic	Glossy	F3-07B	F3-07B-303
3/16	0.8	0.200	3/4	Phenolic	Glossy	F3-08B	F3-08B-303
3/16	0.9	0.200	3/4	Phenolic	Glossy	F3-09B	F3-09B-303
3/16	1.0	0.200	3/4	Phenolic	Glossy	F3-10B	F3-10B-303
3/16	1.1	0.200	3/4	Phenolic	Glossy	F3-11B	F3-11B-303
3/16	1.2	0.200	3/4	Phenolic	Glossy	F3-12B	F3-12B-303
3/16	1.3	0.200	3/4	Phenolic	Glossy	F3-13B	F3-13B-303
3/16	1.4	0.200	3/4	Phenolic	Glossy	F3-14B	F3-14B-303
3/16	1.5	0.200	3/4	Phenolic	Glossy	F3-15B	F3-15B-303
3/16	1.6	0.200	3/4	Phenolic	Glossy	F3-16B	F3-16B-303
3/16	1.7	0.200	3/4	Phenolic	Glossy	F3-17B	F3-17B-303
3/16	1.8	0.200	3/4	Phenolic	Glossy	F3-18B	F3-18B-303
3/16	1.9	0.200	3/4	Phenolic	Glossy	F3-19B	F3-19B-303
3/16	2.0	0.200	3/4	Phenolic	Glossy	F3-20B	F3-20B-303
3/16	2.1	0.200	3/4	Phenolic	Glossy	F3-21B	F3-21B-303
3/16	2.2	0.200	3/4	Phenolic	Glossy	F3-22B	F3-22B-303
3/16	2.3	0.200	3/4	Phenolic	Glossy	F3-23B	F3-23B-303
3/16	2.4	0.200	3/4	Phenolic	Glossy	F3-24B	F3-24B-303
3/16	2.5	0.200	3/4	Phenolic	Glossy	F3-25B	F3-25B-303
3/16	2.6	0.200	3/4	Phenolic	Glossy	F3-26B	F3-26B-303
3/16	2.7	0.200	3/4	Phenolic	Glossy	F3-27B	F3-27B-303
3/16	2.8	0.200	3/4	Phenolic	Glossy	F3-28B	F3-28B-303
3/16	2.9	0.200	3/4	Phenolic	Glossy	F3-29B	F3-29B-303
3/16	3.0	0.200	3/4	Phenolic	Glossy	F3-30B	F3-30B-303
1/4	0.5	0.312	1-1/4	Polypropylene	Textured	F4-05B	F4-05B-303
1/4	0.6	0.312	1-1/4	Polypropylene	Textured	F4-06B	F4-06B-303
1/4	0.7	0.312	1-1/4	Polypropylene	Textured	F4-07B	F4-07B-303

**Model F Faspin – Ball Handle**

DIAMETER	GRIP OR EFFECTIVE LENGTH	C	Size	Material	Finish	FASPIN P/N ZINC PLATED 1144 STEEL	FASPIN P/N 303 STAINLESS STEEL
1/4	0.8	0.312	1-1/4	Polypropylene	Textured	F4-08B	F4-08B-303
1/4	0.9	0.312	1-1/4	Polypropylene	Textured	F4-09B	F4-09B-303
1/4	1.0	0.312	1-1/4	Polypropylene	Textured	F4-10B	F4-10B-303
1/4	1.1	0.312	1-1/4	Polypropylene	Textured	F4-11B	F4-11B-303
1/4	1.2	0.312	1-1/4	Polypropylene	Textured	F4-12B	F4-12B-303
1/4	1.3	0.312	1-1/4	Polypropylene	Textured	F4-13B	F4-13B-303
1/4	1.4	0.312	1-1/4	Polypropylene	Textured	F4-14B	F4-14B-303
1/4	1.5	0.312	1-1/4	Polypropylene	Textured	F4-15B	F4-15B-303
1/4	1.6	0.312	1-1/4	Polypropylene	Textured	F4-16B	F4-16B-303
1/4	1.7	0.312	1-1/4	Polypropylene	Textured	F4-17B	F4-17B-303
1/4	1.8	0.312	1-1/4	Polypropylene	Textured	F4-18B	F4-18B-303
1/4	1.9	0.312	1-1/4	Polypropylene	Textured	F4-19B	F4-19B-303
1/4	2.0	0.312	1-1/4	Polypropylene	Textured	F4-20B	F4-20B-303
1/4	2.1	0.312	1-1/4	Polypropylene	Textured	F4-21B	F4-21B-303
1/4	2.2	0.312	1-1/4	Polypropylene	Textured	F4-22B	F4-22B-303
1/4	2.3	0.312	1-1/4	Polypropylene	Textured	F4-23B	F4-23B-303
1/4	2.4	0.312	1-1/4	Polypropylene	Textured	F4-24B	F4-24B-303
1/4	2.5	0.312	1-1/4	Polypropylene	Textured	F4-25B	F4-25B-303
1/4	2.6	0.312	1-1/4	Polypropylene	Textured	F4-26B	F4-26B-303
1/4	2.7	0.312	1-1/4	Polypropylene	Textured	F4-27B	F4-27B-303
1/4	2.8	0.312	1-1/4	Polypropylene	Textured	F4-28B	F4-28B-303
1/4	2.9	0.312	1-1/4	Polypropylene	Textured	F4-29B	F4-29B-303
1/4	3.0	0.312	1-1/4	Polypropylene	Textured	F4-30B	F4-30B-303
5/16	0.5	0.375	1-1/4	Polypropylene	Textured	F5-05B	F5-05B-303
5/16	0.6	0.375	1-1/4	Polypropylene	Textured	F5-06B	F5-06B-303
5/16	0.7	0.375	1-1/4	Polypropylene	Textured	F5-07B	F5-07B-303
5/16	0.8	0.375	1-1/4	Polypropylene	Textured	F5-08B	F5-08B-303
5/16	0.9	0.375	1-1/4	Polypropylene	Textured	F5-09B	F5-09B-303
5/16	1.0	0.375	1-1/4	Polypropylene	Textured	F5-10B	F5-10B-303
5/16	1.1	0.375	1-1/4	Polypropylene	Textured	F5-11B	F5-11B-303
5/16	1.2	0.375	1-1/4	Polypropylene	Textured	F5-12B	F5-12B-303
5/16	1.3	0.375	1-1/4	Polypropylene	Textured	F5-13B	F5-13B-303
5/16	1.4	0.375	1-1/4	Polypropylene	Textured	F5-14B	F5-14B-303
5/16	1.5	0.375	1-1/4	Polypropylene	Textured	F5-15B	F5-15B-303
5/16	1.6	0.375	1-1/4	Polypropylene	Textured	F5-16B	F5-16B-303
5/16	1.7	0.375	1-1/4	Polypropylene	Textured	F5-17B	F5-17B-303
5/16	1.8	0.375	1-1/4	Polypropylene	Textured	F5-18B	F5-18B-303
5/16	1.9	0.375	1-1/4	Polypropylene	Textured	F5-19B	F5-19B-303
5/16	2.0	0.375	1-1/4	Polypropylene	Textured	F5-20B	F5-20B-303
5/16	2.1	0.375	1-1/4	Polypropylene	Textured	F5-21B	F5-21B-303
5/16	2.2	0.375	1-1/4	Polypropylene	Textured	F5-22B	F5-22B-303
5/16	2.3	0.375	1-1/4	Polypropylene	Textured	F5-23B	F5-23B-303
5/16	2.4	0.375	1-1/4	Polypropylene	Textured	F5-24B	F5-24B-303
5/16	2.5	0.375	1-1/4	Polypropylene	Textured	F5-25B	F5-25B-303

**Model F Faspin – Ball Handle**

DIAMETER	GRIP OR EFFECTIVE LENGTH	C	Size	Material	Finish	FASPIN P/N ZINC PLATED 1144 STEEL	FASPIN P/N 303 STAINLESS STEEL
5/16	2.6	0.375	1-1/4	Polypropylene	Textured	F5-26B	F5-26B-303
5/16	2.7	0.375	1-1/4	Polypropylene	Textured	F5-27B	F5-27B-303
5/16	2.8	0.375	1-1/4	Polypropylene	Textured	F5-28B	F5-28B-303
5/16	2.9	0.375	1-1/4	Polypropylene	Textured	F5-29B	F5-29B-303
5/16	3.0	0.375	1-1/4	Polypropylene	Textured	F5-30B	F5-30B-303
3/8	0.5	0.500	1-1/4	Polypropylene	Textured	F6-05B	F6-05B-303
3/8	0.6	0.500	1-1/4	Polypropylene	Textured	F6-06B	F6-06B-303
3/8	0.7	0.500	1-1/4	Polypropylene	Textured	F6-07B	F6-07B-303
3/8	0.8	0.500	1-1/4	Polypropylene	Textured	F6-08B	F6-08B-303
3/8	0.9	0.500	1-1/4	Polypropylene	Textured	F6-09B	F6-09B-303
3/8	1.0	0.500	1-1/4	Polypropylene	Textured	F6-10B	F6-10B-303
3/8	1.1	0.500	1-1/4	Polypropylene	Textured	F6-11B	F6-11B-303
3/8	1.2	0.500	1-1/4	Polypropylene	Textured	F6-12B	F6-12B-303
3/8	1.3	0.500	1-1/4	Polypropylene	Textured	F6-13B	F6-13B-303
3/8	1.4	0.500	1-1/4	Polypropylene	Textured	F6-14B	F6-14B-303
3/8	1.5	0.500	1-1/4	Polypropylene	Textured	F6-15B	F6-15B-303
3/8	1.6	0.500	1-1/4	Polypropylene	Textured	F6-16B	F6-16B-303
3/8	1.7	0.500	1-1/4	Polypropylene	Textured	F6-17B	F6-17B-303
3/8	1.8	0.500	1-1/4	Polypropylene	Textured	F6-18B	F6-18B-303
3/8	1.9	0.500	1-1/4	Polypropylene	Textured	F6-19B	F6-19B-303
3/8	2.0	0.500	1-1/4	Polypropylene	Textured	F6-20B	F6-20B-303
3/8	2.1	0.500	1-1/4	Polypropylene	Textured	F6-21B	F6-21B-303
3/8	2.2	0.500	1-1/4	Polypropylene	Textured	F6-22B	F6-22B-303
3/8	2.3	0.500	1-1/4	Polypropylene	Textured	F6-23B	F6-23B-303
3/8	2.4	0.500	1-1/4	Polypropylene	Textured	F6-24B	F6-24B-303
3/8	2.5	0.500	1-1/4	Polypropylene	Textured	F6-25B	F6-25B-303
3/8	2.6	0.500	1-1/4	Polypropylene	Textured	F6-26B	F6-26B-303
3/8	2.7	0.500	1-1/4	Polypropylene	Textured	F6-27B	F6-27B-303
3/8	2.8	0.500	1-1/4	Polypropylene	Textured	F6-28B	F6-28B-303
3/8	2.9	0.500	1-1/4	Polypropylene	Textured	F6-29B	F6-29B-303
3/8	3.0	0.500	1-1/4	Polypropylene	Textured	F6-30B	F6-30B-303
3/8	3.1	0.500	1-1/4	Polypropylene	Textured	F6-31B	F6-31B-303
3/8	3.2	0.500	1-1/4	Polypropylene	Textured	F6-32B	F6-32B-303
3/8	3.3	0.500	1-1/4	Polypropylene	Textured	F6-33B	F6-33B-303
3/8	3.4	0.500	1-1/4	Polypropylene	Textured	F6-34B	F6-34B-303
3/8	3.5	0.500	1-1/4	Polypropylene	Textured	F6-35B	F6-35B-303
3/8	3.6	0.500	1-1/4	Polypropylene	Textured	F6-36B	F6-36B-303
3/8	3.7	0.500	1-1/4	Polypropylene	Textured	F6-37B	F6-37B-303
3/8	3.8	0.500	1-1/4	Polypropylene	Textured	F6-38B	F6-38B-303
3/8	3.9	0.500	1-1/4	Polypropylene	Textured	F6-39B	F6-39B-303
3/8	4.0	0.500	1-1/4	Polypropylene	Textured	F6-40B	F6-40B-303
1/2	0.5	0.625	1-1/2	Polypropylene	Textured	F8-05B	F8-05B-303
1/2	0.6	0.625	1-1/2	Polypropylene	Textured	F8-06B	F8-06B-303
1/2	0.7	0.625	1-1/2	Polypropylene	Textured	F8-07B	F8-07B-303

**Model F Faspin – Ball Handle**

DIAMETER	GRIP OR EFFECTIVE LENGTH	C	Size	Material	Finish	FASPIN P/N ZINC PLATED 1144 STEEL	FASPIN P/N 303 STAINLESS STEEL
1/2	0.8	0.625	1-1/2	Polypropylene	Textured	F8-08B	F8-08B-303
1/2	0.9	0.625	1-1/2	Polypropylene	Textured	F8-09B	F8-09B-303
1/2	1.0	0.625	1-1/2	Polypropylene	Textured	F8-10B	F8-10B-303
1/2	1.1	0.625	1-1/2	Polypropylene	Textured	F8-11B	F8-11B-303
1/2	1.2	0.625	1-1/2	Polypropylene	Textured	F8-12B	F8-12B-303
1/2	1.3	0.625	1-1/2	Polypropylene	Textured	F8-13B	F8-13B-303
1/2	1.4	0.625	1-1/2	Polypropylene	Textured	F8-14B	F8-14B-303
1/2	1.5	0.625	1-1/2	Polypropylene	Textured	F8-15B	F8-15B-303
1/2	1.6	0.625	1-1/2	Polypropylene	Textured	F8-16B	F8-16B-303
1/2	1.7	0.625	1-1/2	Polypropylene	Textured	F8-17B	F8-17B-303
1/2	1.8	0.625	1-1/2	Polypropylene	Textured	F8-18B	F8-18B-303
1/2	1.9	0.625	1-1/2	Polypropylene	Textured	F8-19B	F8-19B-303
1/2	2.0	0.625	1-1/2	Polypropylene	Textured	F8-20B	F8-20B-303
1/2	2.1	0.625	1-1/2	Polypropylene	Textured	F8-21B	F8-21B-303
1/2	2.2	0.625	1-1/2	Polypropylene	Textured	F8-22B	F8-22B-303
1/2	2.3	0.625	1-1/2	Polypropylene	Textured	F8-23B	F8-23B-303
1/2	2.4	0.625	1-1/2	Polypropylene	Textured	F8-24B	F8-24B-303
1/2	2.5	0.625	1-1/2	Polypropylene	Textured	F8-25B	F8-25B-303
1/2	2.6	0.625	1-1/2	Polypropylene	Textured	F8-26B	F8-26B-303
1/2	2.7	0.625	1-1/2	Polypropylene	Textured	F8-27B	F8-27B-303
1/2	2.8	0.625	1-1/2	Polypropylene	Textured	F8-28B	F8-28B-303
1/2	2.9	0.625	1-1/2	Polypropylene	Textured	F8-29B	F8-29B-303
1/2	3.0	0.625	1-1/2	Polypropylene	Textured	F8-30B	F8-30B-303
1/2	3.1	0.625	1-1/2	Polypropylene	Textured	F8-31B	F8-31B-303
1/2	3.2	0.625	1-1/2	Polypropylene	Textured	F8-32B	F8-32B-303
1/2	3.3	0.625	1-1/2	Polypropylene	Textured	F8-33B	F8-33B-303
1/2	3.4	0.625	1-1/2	Polypropylene	Textured	F8-34B	F8-34B-303
1/2	3.5	0.625	1-1/2	Polypropylene	Textured	F8-35B	F8-35B-303
1/2	3.6	0.625	1-1/2	Polypropylene	Textured	F8-36B	F8-36B-303
1/2	3.7	0.625	1-1/2	Polypropylene	Textured	F8-37B	F8-37B-303
1/2	3.8	0.625	1-1/2	Polypropylene	Textured	F8-38B	F8-38B-303
1/2	3.9	0.625	1-1/2	Polypropylene	Textured	F8-39B	F8-39B-303
1/2	4.0	0.625	1-1/2	Polypropylene	Textured	F8-40B	F8-40B-303
1/2	4.1	0.625	1-1/2	Polypropylene	Textured	F8-41B	F8-41B-303
1/2	4.2	0.625	1-1/2	Polypropylene	Textured	F8-42B	F8-42B-303
1/2	4.3	0.625	1-1/2	Polypropylene	Textured	F8-43B	F8-43B-303
1/2	4.4	0.625	1-1/2	Polypropylene	Textured	F8-44B	F8-44B-303
1/2	4.5	0.625	1-1/2	Polypropylene	Textured	F8-45B	F8-45B-303
1/2	4.6	0.625	1-1/2	Polypropylene	Textured	F8-46B	F8-46B-303
1/2	4.7	0.625	1-1/2	Polypropylene	Textured	F8-47B	F8-47B-303
1/2	4.8	0.625	1-1/2	Polypropylene	Textured	F8-48B	F8-48B-303
1/2	4.9	0.625	1-1/2	Polypropylene	Textured	F8-49B	F8-49B-303
1/2	5.0	0.625	1-1/2	Polypropylene	Textured	F8-50B	F8-50B-303

# Model F Faspin®

Standard sizes and configurations.

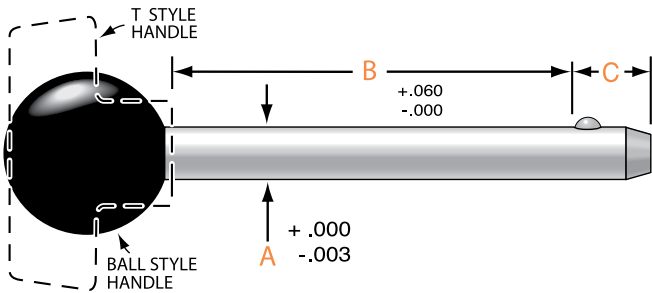

## Ball Handle T Handle

### Model F – T Handle

DIAMETER	GRIP OR EFFECTIVE LENGTH	C	Size	Material	Finish	FASPIN P/N ZINC PLATED 1144 STEEL	FASPIN P/N 303 STAINLESS STEEL
3/16	0.5	0.200	2 x 1-1/8 x 3/4	Polypropylene	Textured	F3-05T	F3-05T-303
3/16	0.6	0.200	2 x 1-1/8 x 3/4	Polypropylene	Textured	F3-06T	F3-06T-303
3/16	0.7	0.200	2 x 1-1/8 x 3/4	Polypropylene	Textured	F3-07T	F3-07T-303
3/16	0.8	0.200	2 x 1-1/8 x 3/4	Polypropylene	Textured	F3-08T	F3-08T-303
3/16	0.9	0.200	2 x 1-1/8 x 3/4	Polypropylene	Textured	F3-09T	F3-09T-303
3/16	1.0	0.200	2 x 1-1/8 x 3/4	Polypropylene	Textured	F3-10T	F3-10T-303
3/16	1.1	0.200	2 x 1-1/8 x 3/4	Polypropylene	Textured	F3-11T	F3-11T-303
3/16	1.2	0.200	2 x 1-1/8 x 3/4	Polypropylene	Textured	F3-12T	F3-12T-303
3/16	1.3	0.200	2 x 1-1/8 x 3/4	Polypropylene	Textured	F3-13T	F3-13T-303
3/16	1.4	0.200	2 x 1-1/8 x 3/4	Polypropylene	Textured	F3-14T	F3-14T-303
3/16	1.5	0.200	2 x 1-1/8 x 3/4	Polypropylene	Textured	F3-15T	F3-15T-303
3/16	1.6	0.200	2 x 1-1/8 x 3/4	Polypropylene	Textured	F3-16T	F3-16T-303
3/16	1.7	0.200	2 x 1-1/8 x 3/4	Polypropylene	Textured	F3-17T	F3-17T-303
3/16	1.8	0.200	2 x 1-1/8 x 3/4	Polypropylene	Textured	F3-18T	F3-18T-303
3/16	1.9	0.200	2 x 1-1/8 x 3/4	Polypropylene	Textured	F3-19T	F3-19T-303
3/16	2.0	0.200	2 x 1-1/8 x 3/4	Polypropylene	Textured	F3-20T	F3-20T-303
3/16	2.1	0.200	2 x 1-1/8 x 3/4	Polypropylene	Textured	F3-21T	F3-21T-303
3/16	2.2	0.200	2 x 1-1/8 x 3/4	Polypropylene	Textured	F3-22T	F3-22T-303
3/16	2.3	0.200	2 x 1-1/8 x 3/4	Polypropylene	Textured	F3-23T	F3-23T-303
3/16	2.4	0.200	2 x 1-1/8 x 3/4	Polypropylene	Textured	F3-24T	F3-24T-303
3/16	2.5	0.200	2 x 1-1/8 x 3/4	Polypropylene	Textured	F3-25T	F3-25T-303
3/16	2.6	0.200	2 x 1-1/8 x 3/4	Polypropylene	Textured	F3-26T	F3-26T-303
3/16	2.7	0.200	2 x 1-1/8 x 3/4	Polypropylene	Textured	F3-27T	F3-27T-303
3/16	2.8	0.200	2 x 1-1/8 x 3/4	Polypropylene	Textured	F3-28T	F3-28T-303
3/16	2.9	0.200	2 x 1-1/8 x 3/4	Polypropylene	Textured	F3-29T	F3-29T-303
3/16	3.0	0.200	2 x 1-1/8 x 3/4	Polypropylene	Textured	F3-30T	F3-30T-303
1/4	0.5	0.312	2 x 1-1/8 x 3/4	Polypropylene	Textured	F4-05T	F4-05T-303
1/4	0.6	0.312	2 x 1-1/8 x 3/4	Polypropylene	Textured	F4-06T	F4-06T-303
1/4	0.7	0.312	2 x 1-1/8 x 3/4	Polypropylene	Textured	F4-07T	F4-07T-303
1/4	0.8	0.312	2 x 1-1/8 x 3/4	Polypropylene	Textured	F4-08T	F4-08T-303

**Model F Faspin – T Handle**

DIAMETER	GRIP OR EFFECTIVE LENGTH	C	Size	Material	Finish	FASPIN P/N ZINC PLATED 1144 STEEL	FASPIN P/N 303 STAINLESS STEEL
1/4	0.9	0.312	2 x 1-1/8 x 3/4	Polypropylene	Textured	F4-09T	F4-09T-303
1/4	1.0	0.312	2 x 1-1/8 x 3/4	Polypropylene	Textured	F4-10T	F4-10T-303
1/4	1.1	0.312	2 x 1-1/8 x 3/4	Polypropylene	Textured	F4-11T	F4-11T-303
1/4	1.2	0.312	2 x 1-1/8 x 3/4	Polypropylene	Textured	F4-12T	F4-12T-303
1/4	1.3	0.312	2 x 1-1/8 x 3/4	Polypropylene	Textured	F4-13T	F4-13T-303
1/4	1.4	0.312	2 x 1-1/8 x 3/4	Polypropylene	Textured	F4-14T	F4-14T-303
1/4	1.5	0.312	2 x 1-1/8 x 3/4	Polypropylene	Textured	F4-15T	F4-15T-303
1/4	1.6	0.312	2 x 1-1/8 x 3/4	Polypropylene	Textured	F4-16T	F4-16T-303
1/4	1.7	0.312	2 x 1-1/8 x 3/4	Polypropylene	Textured	F4-17T	F4-17T-303
1/4	1.8	0.312	2 x 1-1/8 x 3/4	Polypropylene	Textured	F4-18T	F4-18T-303
1/4	1.9	0.312	2 x 1-1/8 x 3/4	Polypropylene	Textured	F4-19T	F4-19T-303
1/4	2.0	0.312	2 x 1-1/8 x 3/4	Polypropylene	Textured	F4-20T	F4-20T-303
1/4	2.1	0.312	2 x 1-1/8 x 3/4	Polypropylene	Textured	F4-21T	F4-21T-303
1/4	2.2	0.312	2 x 1-1/8 x 3/4	Polypropylene	Textured	F4-22T	F4-22T-303
1/4	2.3	0.312	2 x 1-1/8 x 3/4	Polypropylene	Textured	F4-23T	F4-23T-303
1/4	2.4	0.312	2 x 1-1/8 x 3/4	Polypropylene	Textured	F4-24T	F4-24T-303
1/4	2.5	0.312	2 x 1-1/8 x 3/4	Polypropylene	Textured	F4-25T	F4-25T-303
1/4	2.6	0.312	2 x 1-1/8 x 3/4	Polypropylene	Textured	F4-26T	F4-26T-303
1/4	2.7	0.312	2 x 1-1/8 x 3/4	Polypropylene	Textured	F4-27T	F4-27T-303
1/4	2.8	0.312	2 x 1-1/8 x 3/4	Polypropylene	Textured	F4-28T	F4-28T-303
1/4	2.9	0.312	2 x 1-1/8 x 3/4	Polypropylene	Textured	F4-29T	F4-29T-303
1/4	3.0	0.312	2 x 1-1/8 x 3/4	Polypropylene	Textured	F4-30T	F4-30T-303
5/16	0.5	0.375	2 x 1-1/8 x 3/4	Polypropylene	Textured	F5-05T	F5-05T-303
5/16	0.6	0.375	2 x 1-1/8 x 3/4	Polypropylene	Textured	F5-06T	F5-06T-303
5/16	0.7	0.375	2 x 1-1/8 x 3/4	Polypropylene	Textured	F5-07T	F5-07T-303
5/16	0.8	0.375	2 x 1-1/8 x 3/4	Polypropylene	Textured	F5-08T	F5-08T-303
5/16	0.9	0.375	2 x 1-1/8 x 3/4	Polypropylene	Textured	F5-09T	F5-09T-303
5/16	1.0	0.375	2 x 1-1/8 x 3/4	Polypropylene	Textured	F5-10T	F5-10T-303
5/16	1.1	0.375	2 x 1-1/8 x 3/4	Polypropylene	Textured	F5-11T	F5-11T-303
5/16	1.2	0.375	2 x 1-1/8 x 3/4	Polypropylene	Textured	F5-12T	F5-12T-303
5/16	1.3	0.375	2 x 1-1/8 x 3/4	Polypropylene	Textured	F5-13T	F5-13T-303
5/16	1.4	0.375	2 x 1-1/8 x 3/4	Polypropylene	Textured	F5-14T	F5-14T-303
5/16	1.5	0.375	2 x 1-1/8 x 3/4	Polypropylene	Textured	F5-15T	F5-15T-303
5/16	1.6	0.375	2 x 1-1/8 x 3/4	Polypropylene	Textured	F5-16T	F5-16T-303
5/16	1.7	0.375	2 x 1-1/8 x 3/4	Polypropylene	Textured	F5-17T	F5-17T-303
5/16	1.8	0.375	2 x 1-1/8 x 3/4	Polypropylene	Textured	F5-18T	F5-18T-303
5/16	1.9	0.375	2 x 1-1/8 x 3/4	Polypropylene	Textured	F5-19T	F5-19T-303
5/16	2.0	0.375	2 x 1-1/8 x 3/4	Polypropylene	Textured	F5-20T	F5-20T-303
5/16	2.1	0.375	2 x 1-1/8 x 3/4	Polypropylene	Textured	F5-21T	F5-21T-303
5/16	2.2	0.375	2 x 1-1/8 x 3/4	Polypropylene	Textured	F5-22T	F5-22T-303
5/16	2.3	0.375	2 x 1-1/8 x 3/4	Polypropylene	Textured	F5-23T	F5-23T-303
5/16	2.4	0.375	2 x 1-1/8 x 3/4	Polypropylene	Textured	F5-24T	F5-24T-303
5/16	2.5	0.375	2 x 1-1/8 x 3/4	Polypropylene	Textured	F5-25T	F5-25T-303
5/16	2.6	0.375	2 x 1-1/8 x 3/4	Polypropylene	Textured	F5-26T	F5-26T-303

## Model F Faspin – T Handle

DIAMETER	GRIP OR EFFECTIVE LENGTH	C	Size	Material	Finish	FASPIN P/N ZINC PLATED 1144 STEEL	FASPIN P/N 303 STAINLESS STEEL
5/16	2.7	0.375	2 x 1-1/8 x 3/4	Polypropylene	Textured	F5-27T	F5-27T-303
5/16	2.8	0.375	2 x 1-1/8 x 3/4	Polypropylene	Textured	F5-28T	F5-28T-303
5/16	2.9	0.375	2 x 1-1/8 x 3/4	Polypropylene	Textured	F5-29T	F5-29T-303
5/16	3.0	0.375	2 x 1-1/8 x 3/4	Polypropylene	Textured	F5-30T	F5-30T-303
3/8	0.5	0.500	2 x 1-1/8 x 3/4	Polypropylene	Textured	F6-05T	F6-05T-303
3/8	0.6	0.500	2 x 1-1/8 x 3/4	Polypropylene	Textured	F6-06T	F6-06T-303
3/8	0.7	0.500	2 x 1-1/8 x 3/4	Polypropylene	Textured	F6-07T	F6-07T-303
3/8	0.8	0.500	2 x 1-1/8 x 3/4	Polypropylene	Textured	F6-08T	F6-08T-303
3/8	0.9	0.500	2 x 1-1/8 x 3/4	Polypropylene	Textured	F6-09T	F6-09T-303
3/8	1.0	0.500	2 x 1-1/8 x 3/4	Polypropylene	Textured	F6-10T	F6-10T-303
3/8	1.1	0.500	2 x 1-1/8 x 3/4	Polypropylene	Textured	F6-11T	F6-11T-303
3/8	1.2	0.500	2 x 1-1/8 x 3/4	Polypropylene	Textured	F6-12T	F6-12T-303
3/8	1.3	0.500	2 x 1-1/8 x 3/4	Polypropylene	Textured	F6-13T	F6-13T-303
3/8	1.4	0.500	2 x 1-1/8 x 3/4	Polypropylene	Textured	F6-14T	F6-14T-303
3/8	1.5	0.500	2 x 1-1/8 x 3/4	Polypropylene	Textured	F6-15T	F6-15T-303
3/8	1.6	0.500	2 x 1-1/8 x 3/4	Polypropylene	Textured	F6-16T	F6-16T-303
3/8	1.7	0.500	2 x 1-1/8 x 3/4	Polypropylene	Textured	F6-17T	F6-17T-303
3/8	1.8	0.500	2 x 1-1/8 x 3/4	Polypropylene	Textured	F6-18T	F6-18T-303
3/8	1.9	0.500	2 x 1-1/8 x 3/4	Polypropylene	Textured	F6-19T	F6-19T-303
3/8	2.0	0.500	2 x 1-1/8 x 3/4	Polypropylene	Textured	F6-20T	F6-20T-303
3/8	2.1	0.500	2 x 1-1/8 x 3/4	Polypropylene	Textured	F6-21T	F6-21T-303
3/8	2.2	0.500	2 x 1-1/8 x 3/4	Polypropylene	Textured	F6-22T	F6-22T-303
3/8	2.3	0.500	2 x 1-1/8 x 3/4	Polypropylene	Textured	F6-23T	F6-23T-303
3/8	2.4	0.500	2 x 1-1/8 x 3/4	Polypropylene	Textured	F6-24T	F6-24T-303
3/8	2.5	0.500	2 x 1-1/8 x 3/4	Polypropylene	Textured	F6-25T	F6-25T-303
3/8	2.6	0.500	2 x 1-1/8 x 3/4	Polypropylene	Textured	F6-26T	F6-26T-303
3/8	2.7	0.500	2 x 1-1/8 x 3/4	Polypropylene	Textured	F6-27T	F6-27T-303
3/8	2.8	0.500	2 x 1-1/8 x 3/4	Polypropylene	Textured	F6-28T	F6-28T-303
3/8	2.9	0.500	2 x 1-1/8 x 3/4	Polypropylene	Textured	F6-29T	F6-29T-303
3/8	3.0	0.500	2 x 1-1/8 x 3/4	Polypropylene	Textured	F6-30T	F6-30T-303
3/8	3.1	0.500	2 x 1-1/8 x 3/4	Polypropylene	Textured	F6-31T	F6-31T-303
3/8	3.2	0.500	2 x 1-1/8 x 3/4	Polypropylene	Textured	F6-32T	F6-32T-303
3/8	3.3	0.500	2 x 1-1/8 x 3/4	Polypropylene	Textured	F6-33T	F6-33T-303
3/8	3.4	0.500	2 x 1-1/8 x 3/4	Polypropylene	Textured	F6-34T	F6-34T-303
3/8	3.5	0.500	2 x 1-1/8 x 3/4	Polypropylene	Textured	F6-35T	F6-35T-303
3/8	3.6	0.500	2 x 1-1/8 x 3/4	Polypropylene	Textured	F6-36T	F6-36T-303
3/8	3.7	0.500	2 x 1-1/8 x 3/4	Polypropylene	Textured	F6-37T	F6-37T-303
3/8	3.8	0.500	2 x 1-1/8 x 3/4	Polypropylene	Textured	F6-38T	F6-38T-303
3/8	3.9	0.500	2 x 1-1/8 x 3/4	Polypropylene	Textured	F6-39T	F6-39T-303
3/8	4.0	0.500	2 x 1-1/8 x 3/4	Polypropylene	Textured	F6-40T	F6-40T-303
1/2	0.5	0.625	3-1/2 x 1-1/8 x 15/16	Polypropylene	Textured	F8-05T	F8-05T-303
1/2	0.6	0.625	3-1/2 x 1-1/8 x 15/16	Polypropylene	Textured	F8-06T	F8-06T-303



## Model F Faspin – T Handle

DIAMETER	GRIP OR EFFECTIVE LENGTH	C	Size	Material	Finish	FASPIN P/N ZINC PLATED 1144 STEEL	FASPIN P/N 303 STAINLESS STEEL
1/2	0.7	0.625	3-1/2 x 1-1/8 x 15/16	Polypropylene	Textured	F8-07T	F8-07T-303
1/2	0.8	0.625	3-1/2 x 1-1/8 x 15/16	Polypropylene	Textured	F8-08T	F8-08T-303
1/2	0.9	0.625	3-1/2 x 1-1/8 x 15/16	Polypropylene	Textured	F8-09T	F8-09T-303
1/2	1.0	0.625	3-1/2 x 1-1/8 x 15/16	Polypropylene	Textured	F8-10T	F8-10T-303
1/2	1.1	0.625	3-1/2 x 1-1/8 x 15/16	Polypropylene	Textured	F8-11T	F8-11T-303
1/2	1.2	0.625	3-1/2 x 1-1/8 x 15/16	Polypropylene	Textured	F8-12T	F8-12T-303
1/2	1.3	0.625	3-1/2 x 1-1/8 x 15/16	Polypropylene	Textured	F8-13T	F8-13T-303
1/2	1.4	0.625	3-1/2 x 1-1/8 x 15/16	Polypropylene	Textured	F8-14T	F8-14T-303
1/2	1.5	0.625	3-1/2 x 1-1/8 x 15/16	Polypropylene	Textured	F8-15T	F8-15T-303
1/2	1.6	0.625	3-1/2 x 1-1/8 x 15/16	Polypropylene	Textured	F8-16T	F8-16T-303
1/2	1.7	0.625	3-1/2 x 1-1/8 x 15/16	Polypropylene	Textured	F8-17T	F8-17T-303
1/2	1.8	0.625	3-1/2 x 1-1/8 x 15/16	Polypropylene	Textured	F8-18T	F8-18T-303
1/2	1.9	0.625	3-1/2 x 1-1/8 x 15/16	Polypropylene	Textured	F8-19T	F8-19T-303
1/2	2.0	0.625	3-1/2 x 1-1/8 x 15/16	Polypropylene	Textured	F8-20T	F8-20T-303
1/2	2.1	0.625	3-1/2 x 1-1/8 x 15/16	Polypropylene	Textured	F8-21T	F8-21T-303
1/2	2.2	0.625	3-1/2 x 1-1/8 x 15/16	Polypropylene	Textured	F8-22T	F8-22T-303
1/2	2.3	0.625	3-1/2 x 1-1/8 x 15/16	Polypropylene	Textured	F8-23T	F8-23T-303
1/2	2.4	0.625	3-1/2 x 1-1/8 x 15/16	Polypropylene	Textured	F8-24T	F8-24T-303
1/2	2.5	0.625	3-1/2 x 1-1/8 x 15/16	Polypropylene	Textured	F8-25T	F8-25T-303
1/2	2.6	0.625	3-1/2 x 1-1/8 x 15/16	Polypropylene	Textured	F8-26T	F8-26T-303
1/2	2.7	0.625	3-1/2 x 1-1/8 x 15/16	Polypropylene	Textured	F8-27T	F8-27T-303
1/2	2.8	0.625	3-1/2 x 1-1/8 x 15/16	Polypropylene	Textured	F8-28T	F8-28T-303
1/2	2.9	0.625	3-1/2 x 1-1/8 x 15/16	Polypropylene	Textured	F8-29T	F8-29T-303
1/2	3.0	0.625	3-1/2 x 1-1/8 x 15/16	Polypropylene	Textured	F8-30T	F8-30T-303
1/2	3.1	0.625	3-1/2 x 1-1/8 x 15/16	Polypropylene	Textured	F8-31T	F8-31T-303



## Model F Faspin – T Handle

DIAMETER	GRIP OR EFFECTIVE LENGTH	C	Size	Material	Finish	FASPIN P/N ZINC PLATED 1144 STEEL	FASPIN P/N 303 STAINLESS STEEL
1/2	3.2	0.625	3-1/2 x 1-1/8 x 15/16	Polypropylene	Textured	F8-32T	F8-32T-303
1/2	3.3	0.625	3-1/2 x 1-1/8 x 15/16	Polypropylene	Textured	F8-33T	F8-33T-303
1/2	3.4	0.625	3-1/2 x 1-1/8 x 15/16	Polypropylene	Textured	F8-34T	F8-34T-303
1/2	3.5	0.625	3-1/2 x 1-1/8 x 15/16	Polypropylene	Textured	F8-35T	F8-35T-303
1/2	3.6	0.625	3-1/2 x 1-1/8 x 15/16	Polypropylene	Textured	F8-36T	F8-36T-303
1/2	3.7	0.625	3-1/2 x 1-1/8 x 15/16	Polypropylene	Textured	F8-37T	F8-37T-303
1/2	3.8	0.625	3-1/2 x 1-1/8 x 15/16	Polypropylene	Textured	F8-38T	F8-38T-303
1/2	3.9	0.625	3-1/2 x 1-1/8 x 15/16	Polypropylene	Textured	F8-39T	F8-39T-303
1/2	4.0	0.625	3-1/2 x 1-1/8 x 15/16	Polypropylene	Textured	F8-40T	F8-40T-303
1/2	4.1	0.625	3-1/2 x 1-1/8 x 15/16	Polypropylene	Textured	F8-41T	F8-41T-303
1/2	4.2	0.625	3-1/2 x 1-1/8 x 15/16	Polypropylene	Textured	F8-42T	F8-42T-303
1/2	4.3	0.625	3-1/2 x 1-1/8 x 15/16	Polypropylene	Textured	F8-43T	F8-43T-303
1/2	4.4	0.625	3-1/2 x 1-1/8 x 15/16	Polypropylene	Textured	F8-44T	F8-44T-303
1/2	4.5	0.625	3-1/2 x 1-1/8 x 15/16	Polypropylene	Textured	F8-45T	F8-45T-303
1/2	4.6	0.625	3-1/2 x 1-1/8 x 15/16	Polypropylene	Textured	F8-46T	F8-46T-303
1/2	4.7	0.625	3-1/2 x 1-1/8 x 15/16	Polypropylene	Textured	F8-47T	F8-47T-303
1/2	4.8	0.625	3-1/2 x 1-1/8 x 15/16	Polypropylene	Textured	F8-48T	F8-48T-303
1/2	4.9	0.625	3-1/2 x 1-1/8 x 15/16	Polypropylene	Textured	F8-49T	F8-49T-303
1/2	5.0	0.625	3-1/2 x 1-1/8 x 15/16	Polypropylene	Textured	F8-50T	F8-50T-303